

## General Advice:

- These instructions are intended as a guide only, if you are in any doubt you should seek the advice of a qualified professional.
- Take care not to mark finished parts with screwdrivers or other tools.
- Use a pair of rubber gloves to get a better grip on decorative hand tight parts.
- Ensure all parts are reassembled tightly.
- After maintenance test that all assemblies are water tight and function correctly.
- Always isolate the hot and cold water supplies before starting any maintenance, once isolated you should drain any residual water from your system.

## To replace the hot valve:

1. Loosen grub screw (D4) on the underside of handle (D5) using a 2mm A/F allen key.
2. Pull the handle (D5) horizontally away from the tap. Note; spacer (D3) may come out with the handle, if so replace when reassembling.
3. Unscrew the valve cover (D2) by hand.
4. Hold the body of the tap (B1) firmly. Using an adjustable or 17mm ring spanner unscrew the valve (D1).
5. Clean the Inside of chamber (B7) with a soft wet cloth.
6. Reassemble the tap in the reverse order.

## To replace the cold/filter valve:

1. Loosen grub screw (C6) on the underside of handle (C7) using a 2mm A/F allen key.
2. Pull the handle (C7) horizontally away from the body (B1).
3. Unscrew the decorative cover (C4) anticlockwise.
4. Unscrew the valve bush (C3) using a 17mm ring spanner or adjustable wrench.
5. Pull the valve bushes (C2 & C3) away from the tap body (B1)
6. If required remove the o-rings by separating parts (C2 & C3) by pushing down on the thin top part of part (C2) whilst holding the outside of part (C3).
7. Pull the old Aquifier valve cartridge (C1) away from the tap body (B1) and ensure all parts of the valve including the red seal are removed.
8. Clean any debris from the chamber in the tap body (B1).
9. Place the brass cover (C2) on the valve (C1)
10. Place the new Aquifier valve (C1) and valve cover (C2) into the chamber (B1) **ensuring that the pegs on the base of the valve (C1) match up with those in the tap chamber (B1).**
11. Whilst holding the valve in place pass the valve bush (C3) over (C1 & C2) and tighten using a 17mm ring spanner.

## To replace the spout o-rings:

1. Loosen grub screw (A8) on the rear of body (B1) using a 2.5mm A/F allen key.
1. Pull the spout (A4) vertically away from the body (B1).
2. Remove the old o-rings (A6 & A7) using a small screwdriver or similar.
3. If worn, remove the white PTFE spacer (A5).
4. Ensure the inside of the body (B1) and the spout base is clean of dirt and grit with a soft wet cloth.
5. If required locate the new white PTFE spacer (A5).
6. Carefully locate the new O-rings (A6 & A7) onto the spout base (A4).
7. Grease the O-rings thoroughly with silicone or alternative similar grease.
8. Reassemble the tap in the reverse order.

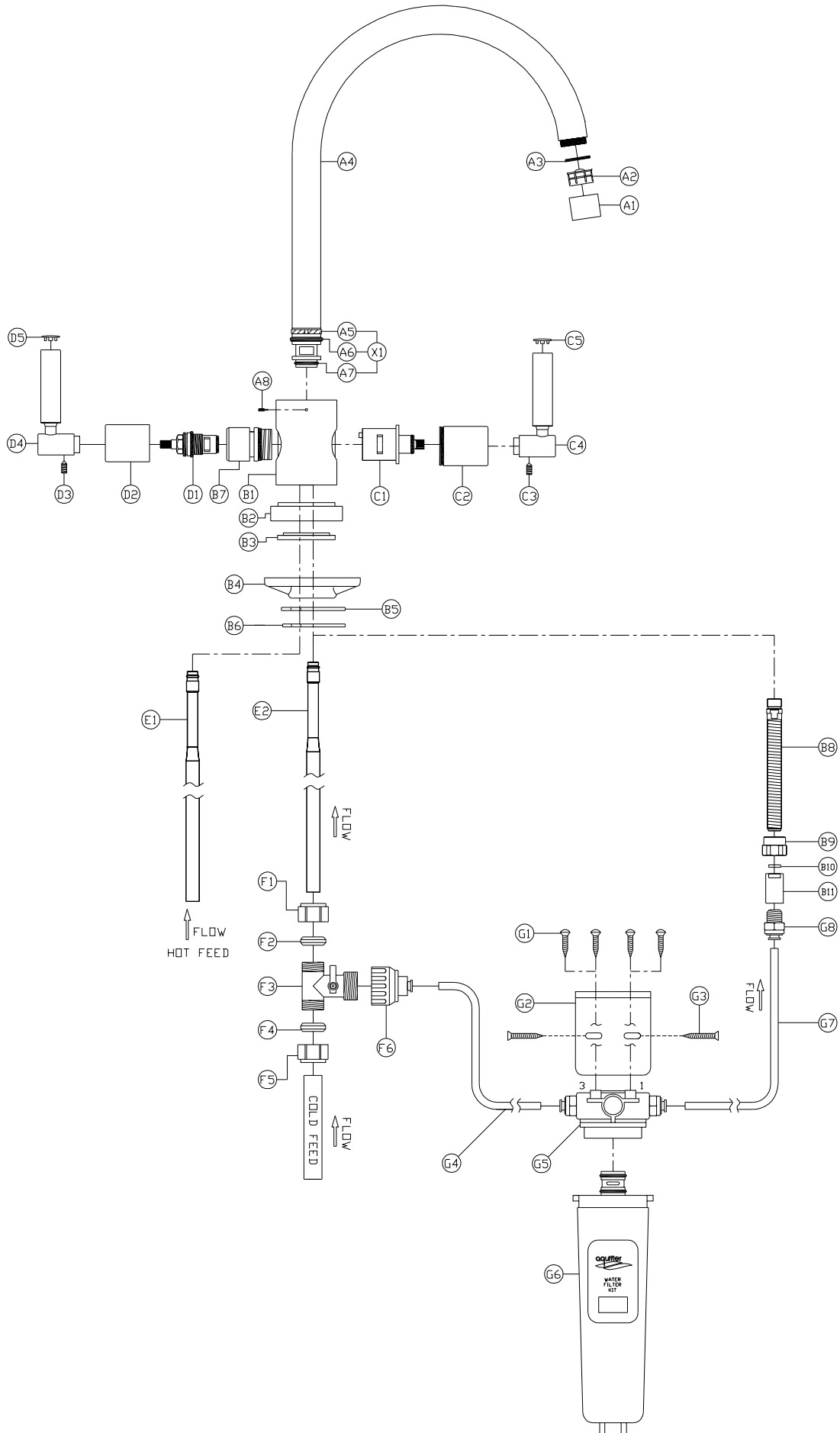

## General Advice:

- These instructions are intended as a guide only, if you are in any doubt you should seek the advice of a qualified professional.
- Take care not to mark finished parts with screwdrivers or other tools.
- Use a pair of rubber gloves to get a better grip on decorative hand tight parts.
- Ensure all parts are reassembled tightly.
- After maintenance test that all assemblies are water tight and function correctly.
- Always isolate the hot and cold water supplies before starting any maintenance, once isolated you should drain any residual water from your system.

## To replace the hot valve:

1. Loosen grub screw (D3) on the underside of handle (D4) using a 2mm A/F allen key.
2. Pull the handle (D4) horizontally away from the tap.
3. Unscrew the valve cover (D2) by hand. If scaled to the body use a 16mm box spanner on the valve cover end.
4. Hold the body of the tap (B1) firmly. Using an adjustable or 17mm ring spanner unscrew the valve (D1).
5. Clean the Inside of chamber (B7) with a soft wet cloth.
6. Reassemble the tap in the reverse order.

## To replace the cold/filter valve:

1. Loosen grub screw (C3) on the underside of handle (C4) using a 2mm A/F allen key.
2. Pull the handle (C4) horizontally away from the body (B1).
3. Unscrew the valve housing (C2) anticlockwise using a 16mm a/f box spanner or a pair of pump pliers and pull it away from the body (B1).  
Note: Ensure jaws of the pump pliers are suitably covered/protected to stop them scratching the valve housing (C2).
4. Pull the old Aquifier valve cartridge (C1) away from the tap body (B1)
5. Clean any debris from the chamber in the tap body (B1).
6. Place the new Aquifier valve (C1) into the valve cover (C2) and push this assembly (C1+C2) into the chamber of (B1) **ensuring that the locating peg on the base of the valve (C1) matches up with the one in the tap chamber (B1).**
7. Push the valve cover (C2) into the body of the tap (B1) and tighten using mole grips.
8. Reassemble the handle (C4) onto the splined section of the valve (C1)

## To replace the spout o-rings:

1. Loosen grub screw (A8) on the rear of body (B1) using a 2.5mm A/F allen key.
2. Pull the spout (A4) vertically away from the body (B1).
3. Remove the old o-rings (A6 & A7) using a small screwdriver or similar.
4. If worn, remove the white PTFE spacer (A5).
5. Ensure the inside of the body (B1) and the spout base is clean of dirt and grit with a soft wet cloth.
6. If required locate the new white PTFE spacer (A5).
7. Carefully locate the new O-rings (A6 & A7) onto the spout base (A4).
8. Grease the O-rings thoroughly with silicone or alternative similar grease.
9. Reassemble the tap in the reverse order.

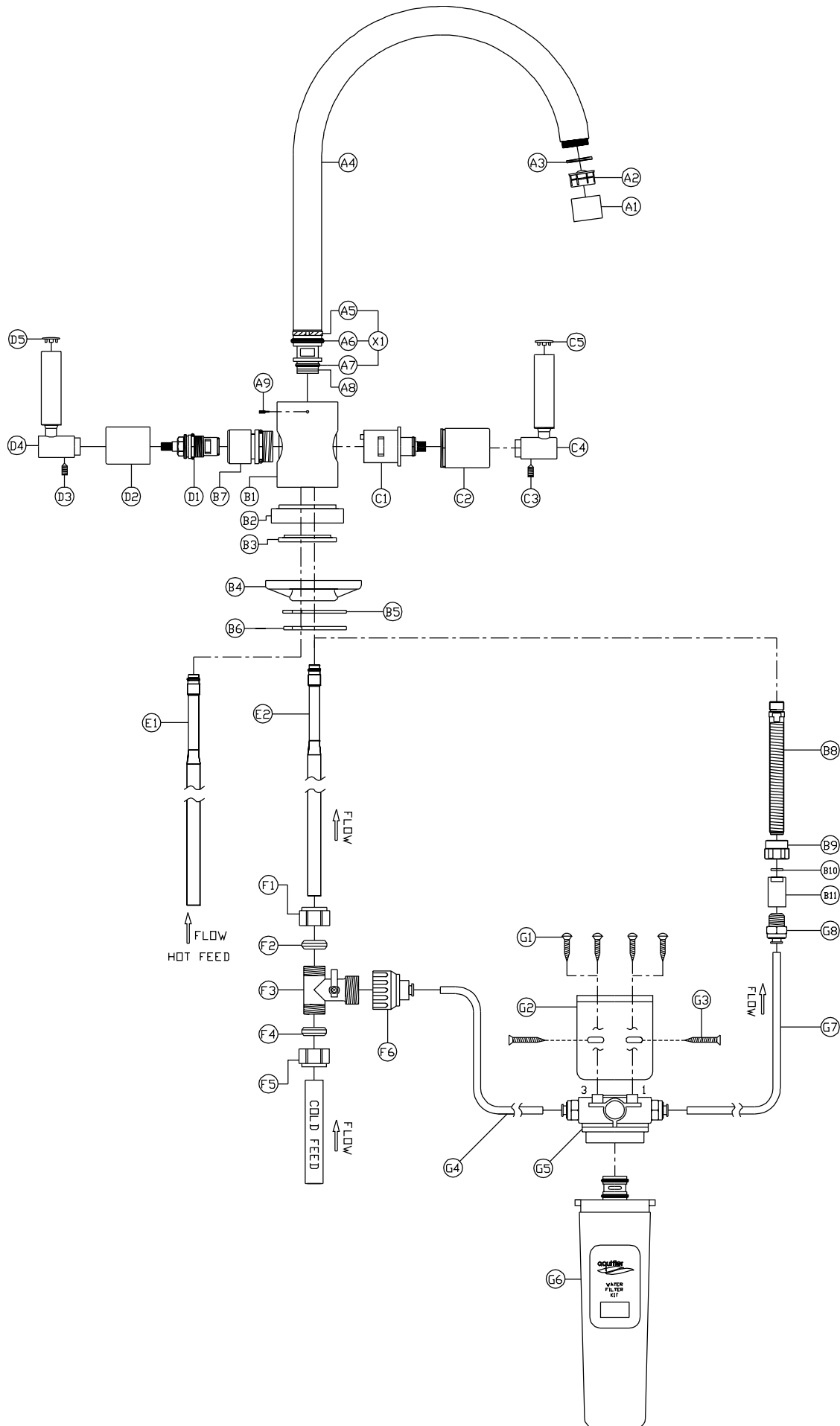

# Atlas Aquifier (Post 2013)

abode

## General Advice:

- These instructions are intended as a guide only, if you are in any doubt you should seek the advice of a qualified professional.
- Take care not to mark finished parts with screwdrivers or other tools.
- Use a pair of rubber gloves to get a better grip on decorative hand tight parts.
- Ensure all parts are reassembled tightly.
- After maintenance test that all assemblies are water tight and function correctly.
- Always isolate the hot and cold water supplies before starting any maintenance, once isolated you should drain any residual water from your system.

## To replace the hot valve:

1. Loosen grub screw (D3) on the underside of handle (D4) using a 2mm A/F allen key.
2. Pull the handle (D4) horizontally away from the tap.
3. Unscrew the valve cover (D2) by hand. If scaled to the body use a 16mm box spanner on the valve cover end.
4. Hold the body of the tap (B1) firmly. Using an adjustable or 17mm ring spanner unscrew the valve (D1).
5. Clean the Inside of chamber (B7) with a soft wet cloth.
6. Reassemble the tap in the reverse order.

## To replace the cold/filter valve:

1. Loosen grub screw (C3) on the underside of handle (C4) using a 2mm A/F allen key.
2. Pull the handle (C4) horizontally away from the body (B1).
9. Unscrew the valve housing (C2) anticlockwise using a 16mm a/f box spanner or a pair of pump pliers and pull it away from the body (B1).  
Note: Ensure jaws of the pump pliers are suitably covered/protected to stop them scratching the valve housing (C2).
3. Pull the old Aquifier valve cartridge (C1) away from the tap body (B1)
4. Clean any debris from the chamber in the tap body (B1).
5. Place the new Aquifier valve (C1) into the valve cover (C2) and push this assembly (C1+C2) into the chamber of (B1) **ensuring that the locating peg on the base of the valve (C1) matches up with the one in the tap chamber (B1).**
6. Push the valve cover (C2) into the body of the tap (B1) and tighten using mole grips.
7. Reassemble the handle (C4) onto the splined section of the valve (C1)

## To replace the spout o-rings:

1. Loosen grub screw (A9) on the rear of body (B1) using a 2.5mm A/F allen key.
2. Pull the spout (A4) vertically away from the body (B1).
3. Remove the old o-rings (A6 & A7) using a small screwdriver or similar.
4. If worn, remove the white PTFE spacer (A5 & A8).
5. Ensure the inside of the body (B1) and the spout base is clean of dirt and grit with a soft wet cloth.
6. If required locate the new white PTFE spacer (A5 & A8).
7. Carefully locate the new O-rings (A6 & A7) onto the spout base (A4).
8. Grease the O-rings thoroughly with silicone or alternative similar grease.
9. Reassemble the tap in the reverse order.